

Setting Up a Dis-Jointed Rollover in Dreamweaver

Before beginning this process, have you...

...created and sized the images you'll be using? (ie: thumbnails and large versions)

...determined where the large images will display when the rollover is activated?

1. Open Dreamweaver, and open the html page you'll be using for the rollover(s). Go to **View > Rulers > Show**, and drag guidelines to indicate where your content boxes (aka: AP Div boxes) will be drawn.

2. Go to the **Layout** tab, and select the **Draw AP Div** icon. Draw the box which will contain the large image. *The blue AP Div box may be resized, if necessary, as well as the image added to the box.*

Drag and drop your image into the box.

3. Click to select the image (ie: thumbnail) which will be used to activate the rollover.

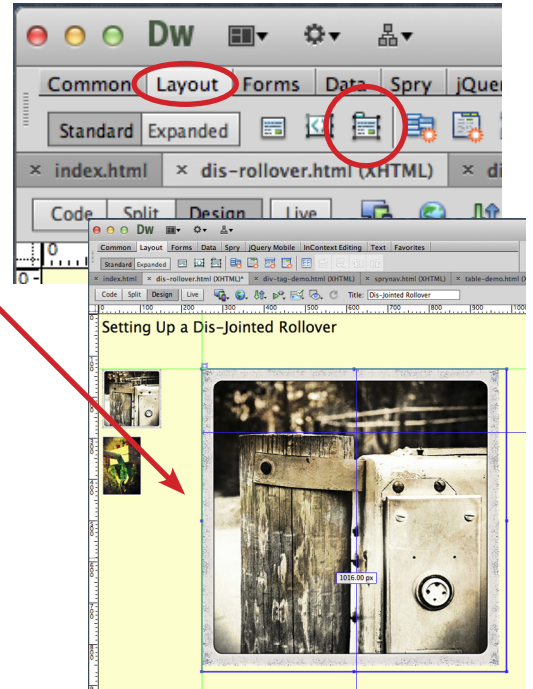
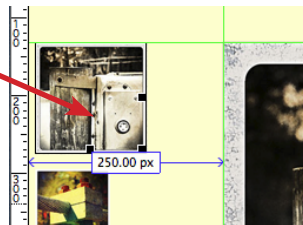

4. After you select the activating image, go to the **Tag Inspector** tab, select the **Behaviors** button, and click the '+' symbol to add a behavior. Choose **Show-Hide Elements**.

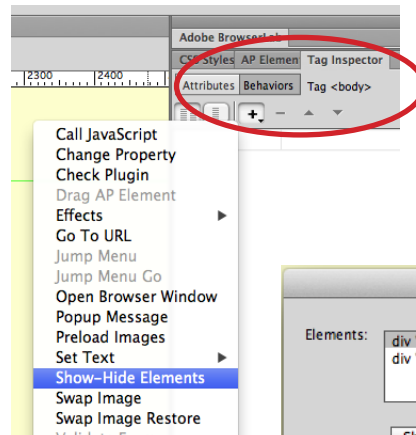

5. In the next box, select the apDiv element you'll control with a behavior, and choose **Show** or **Hide**, then OK.

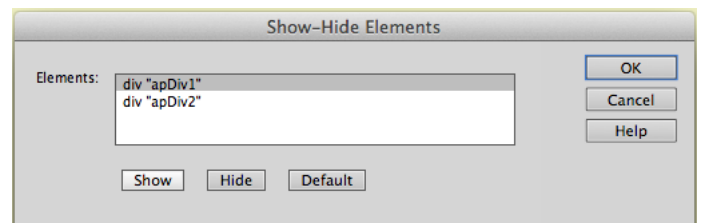

6. Return to the **Tag Inspector** tab to change the default behavior from **onClick** to **onMouseOver** for the **Show** behavior and **onMouseOut** for the **Hide** behavior. *You may need to set each of these twice before the change takes effect. Simply click on the name of the behavior to access a drop-down menu of behaviors.*

7. After completing the first behaviors set-up, go to the **AP Elements** tab (next to the **Tag Inspector** tab) to display the current apDiv box(es). Hover and click next to the apDiv (in the column underneath the eye) and click until a **closed eye** appears. *This will ensure the box will remain hidden on your web page until the onMouseOver behavior to Show is activated.*

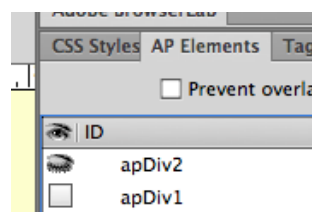

8. Repeat 1-7 for additional dis-jointed rollovers to include on the page.

